

# ERPE2.5/4 - Screw Clamp Terminals

ERPE (Earth Terminals) Series - 4mm<sup>2</sup>

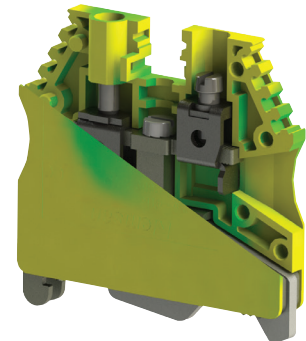

**Dimensions & Weight**

Width	6.00mm
Height (MR35x7.5)	41.00mm
Length	42.00mm
Net Weight	15g

Electrical Ratings	Voltage V~	Current A	Cross-Section
UL	V~	A	AWG 26-10
IEC	V~	A	0.5-4mm <sup>2</sup>
IECEx	630V	57A	0.5-4mm <sup>2</sup>

**Flammability Rating**

UL94	V2
------	----

**Temperature**

Operating Temperature	-55°C to +120°C
-----------------------	-----------------

**Connection Data**

Conductor Cross-Section Solid (min-max)	0.5-6mm <sup>2</sup>
Conductor Cross-Section Stranded (min-max)	0.5-6mm <sup>2</sup>
Conductor Cross-Section Stranded with Ferrules (min-max)	0.5-4mm <sup>2</sup>
2 Conductors with same Cross-Section Stranded, Twin Ferrules with plastic sleeve (min-max)	0.5-2.5mm <sup>2</sup>
AWG Conductor	AWG 26-10
Insulation Stripping Length (min-max)	9-10mm
Connection in Acc. with Standard	IEC 60947-7-1 / 60947-7-2
Torque (min-max)	0.5-0.8Nm
Rail Tightening Torque (min-max)	0.8-1.0Nm

**Ordering Codes** *(please refer to IMO for availability)*

GREEN/YELLOW	ERPE2.5/4
--------------	-----------

**Pack Size**

Quantity	50 Pcs
----------	--------

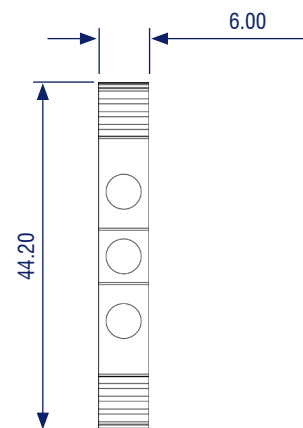
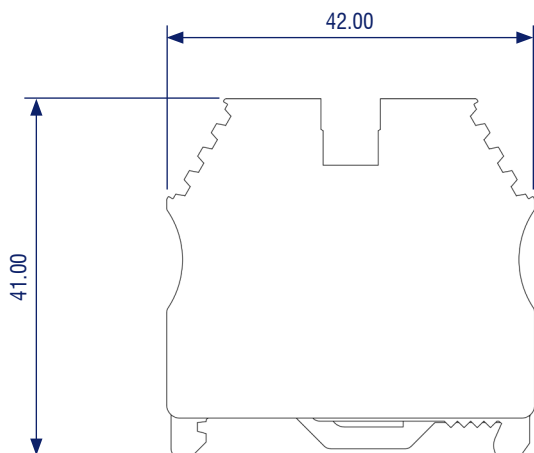

NOTE: Dimensions above are in mm